

**NOTES**

- LEVELS IN m TO ORDINANCE DATUM MALIN HEAD.
- DIMENSIONS IN m.
- FOR SECTION LOCATIONS REFER TO DRAWING NO. PE605-D027-121-001 (LATEST REVISION).

**LEGEND**

TEMPORARILY REGRADED AREA FOR CONSTRUCTION WORKS ACCESS, RESTORED POST WORKS

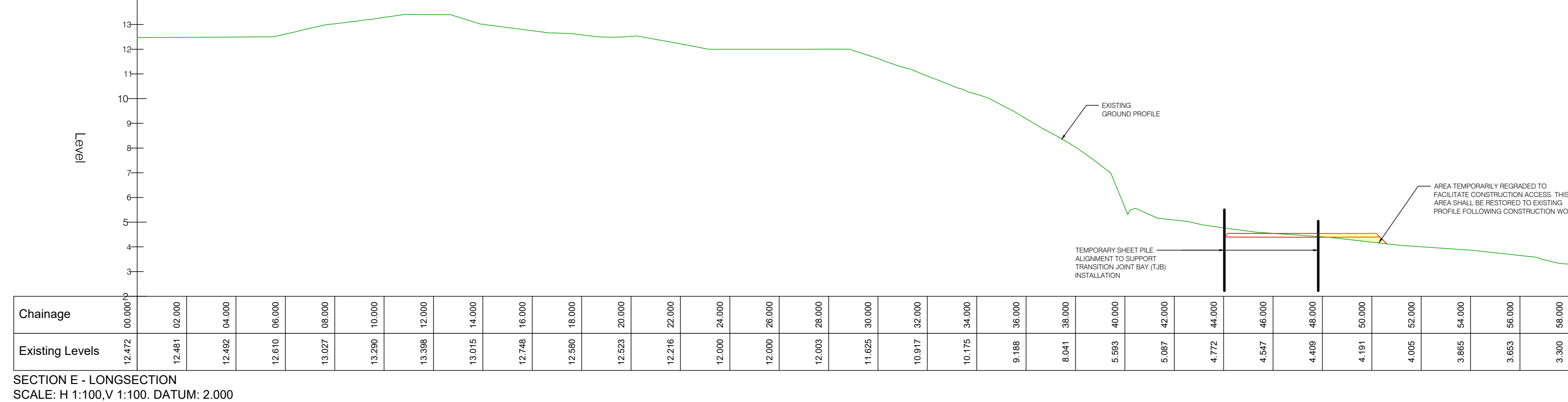
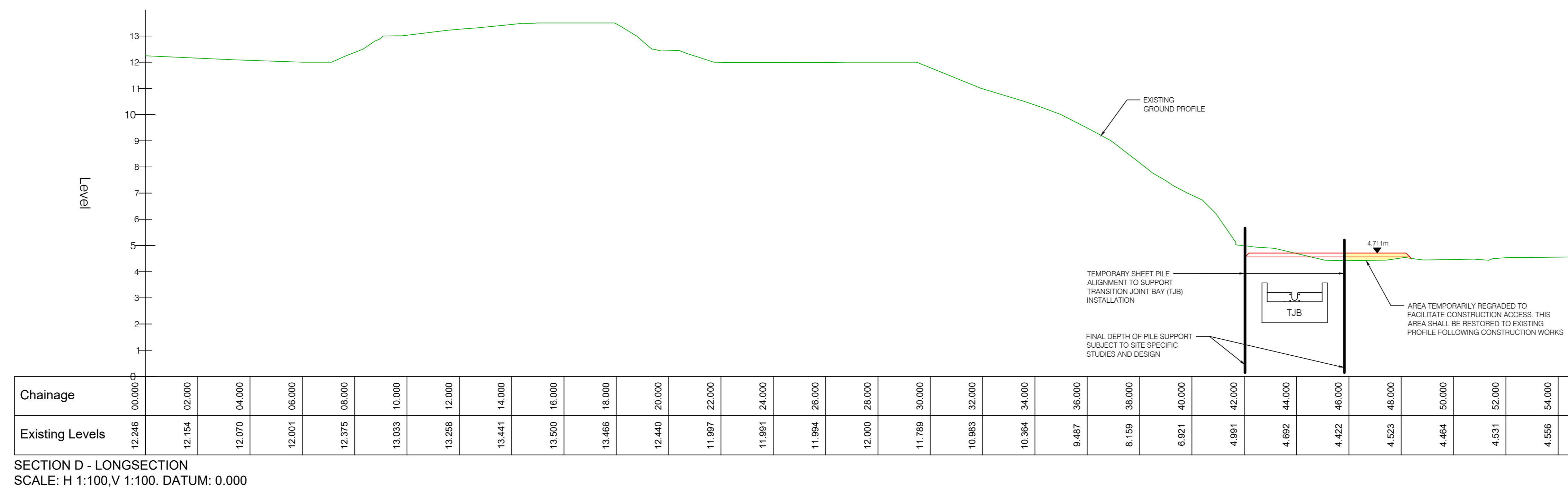
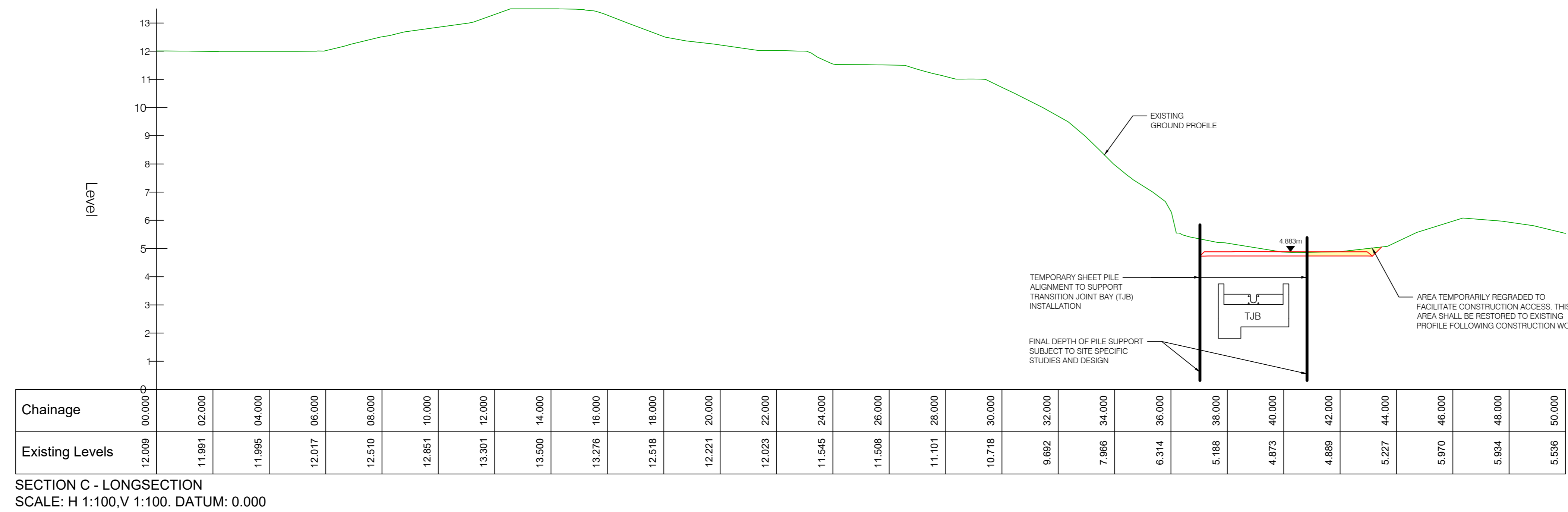
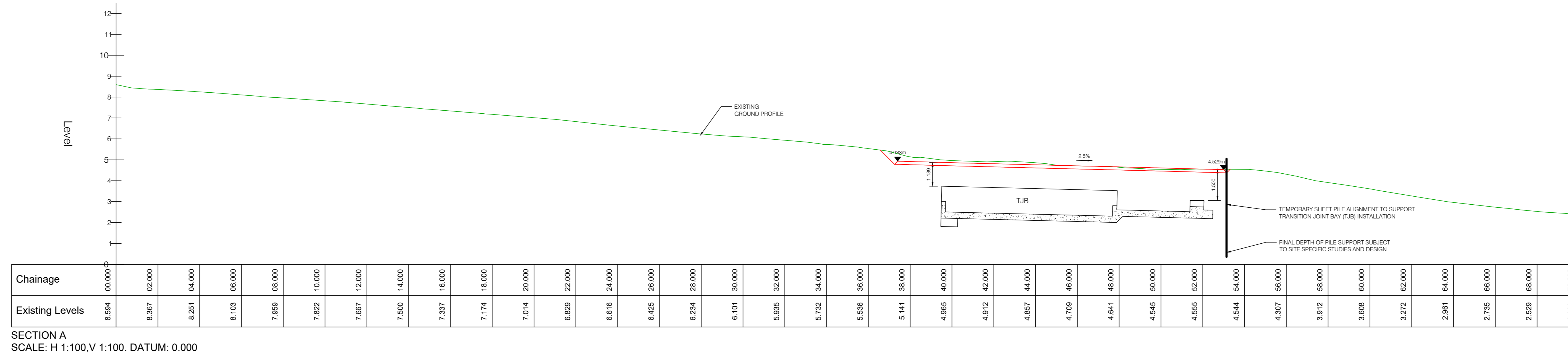

1	LABELS REVISED	SB			
0	28.02.24 ISSUED FOR PLANNING	SB	SB	RD	MH
REV	DATE	REVISION DESCRIPTION	DRN	PROJ	VER

COPYRIGHT © ESS  
ALL RIGHTS RESERVED. NO PART OF THIS WORK MAY BE REPRODUCED, REPRODUCED OR COPIED IN ANY FORM OR BY ANY MEANS - GRAPHIC, ELECTRONIC OR MECHANICAL, INCLUDING PHOTOCOPYING, RECORDING, SCANNING OR USED FOR ANY PURPOSE OTHER THAN ITS DESIGNATED PURPOSE WITHOUT THE WRITTEN PERMISSION OF ESS.

PURPOSE OF ISSUE: PRELIMINARY UNLESS INDICATED  
 CLIENT APPROVAL:  PLANNING  TENDER  CONSTRUCTION  AS-BUILT

CLIENT: Oriel Windfarm Limited

PROJECT: Oriel Wind Farm Project

CONTRACT:

DRAWING TITLE: TRANSITION JOINT BAY ARRANGEMENT OPTION 1 SECTIONS

PRODUCTION UNIT: Civil, Environmental and Renewable Engineering

**ESS** Engineering and Major Projects,  
One Dublin Airport Central, Dublin Airport,  
Cloghan, Co. Dublin, KET 4772, Ireland  
Tel: +353 01 703 8000 Web: www.ess.ie  
Engineering and Major Projects is a division of ESS.

DRAWN	PRODUCED	VERIFIED	APPROVED	APPROVAL DATE
S.Bohan	S.Bohan	R.Dwyer	M.Hogan	01/03/2024
CLIENT REF	NO. OF SHEETS	SHEET	SCALE	
TC20071	1	A0	1:100	

DRAWING NUMBER: PE605-D027-121-002-001